

CITY OF LINDSAY  
BENCH MARK LIST  
PREFACE

The City of Lindsay Bench Mark System was established in 1975 by R. L. Schafer & Associates, Inc.

Elevations are based on a 1959 adjustment of the National Geodetic Survey (formerly Coast and Geodetic Survey) Sea Level Datum of 1929.

The control Bench Mark is located near the Lindsay City Hall building at the Westerly corner of Gale Hill Avenue and Honolulu Street. It is a U.S. Coast and Geodetic Survey bronze disk stamped "LINDSAY 1934" set in concrete.

Bench marks established are 1½-inch brass caps stamped CITY OF LINDSAY BENCH MARK with a number designation.

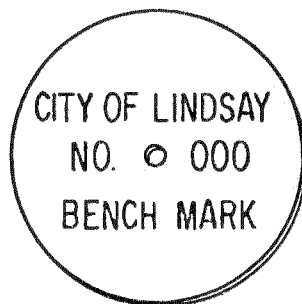

BENCH MARK NO.	DESCRIPTION	ELEVATION
1	U.S. Coast & Geodetic Survey bronze disk stamped "LINDSAY 1934" at the intersection of Gale Hill Avenue and Honolulu Street, 125 feet East of the East corner of City Hall, 10.0 feet Northwest of the Honolulu Street curb and 5.6 feet Southwest of the Gale Hill Avenue curb.	382.47
2	Brass cap 2' North of North curb return, NW corner Mirage Ave. & Honolulu St.	381.13
3	Brass cap, 1' South of South curb return, SE corner Sweetbriar Ave. & Honolulu St.	380.39
* 4	Brass cap, 1.5' South of South curb return, SE corner Sweetbriar Ave. & Hermosa St.	377.50
5	Brass cap, 2' North of North curb return, NE corner Mirage Ave. & Hermosa St.	379.21
6	Brass cap, 2.5' North of North curb return, NE corner Homasell Ave. & Hermosa St.	380.58
7	Brass cap, 1' North of North curb return, NW corner Homasell Ave. & Samoa St.	381.71
8	Brass cap, North of North curb return, NW corner Gale Hill Ave. & Apia St.	383.33
9	Brass cap, North of North curb return, NE corner Foster Ave. & Lindsay St.	384.72
10	Brass cap, East of East curb return, SE corner Mirage Ave. & Lewis St.	383.97
11	Brass cap, 0.5' North of North curb return, NW corner Lewis St. & Sweetbriar Ave.	382.80
12.	Brass cap, 1' South of end curb, NW corner Mount Vernon Ave. & Apia St.	380.58
13	Brass cap, 1' South of South curb return, SW corner Mount Vernon Ave. & Samoa St.	377.64
14	Brass cap, 1' South of South curb return, SW corner Mount Vernon Ave. & Frazier St.	375.24
15	Brass cap, 1.5' West of East end curb on North side of Tulare Road, SE corner Lindsay High School.	392.48

BENCH MARK NO.	DESCRIPTION	ELEVATION
16	Brass cap, 2.3' West of East end curb South side of Tulare Road (600± East of Foothill Avenue)	389.73
17	Brass cap, 3.0' North of North curb return, NE corner Foothill Ave. & Tulare Rd.	387.96
18	Brass cap, 3.5' South of North end curb East side of Foothill Ave. (9.5' North of $\zeta$ Sierra View St.)	387.97
19	Brass cap, 1' North of North curb return, NE corner Fairhaven St. & Foothill Ave.	389.32
20	Brass cap, 1.5' North of North curb return, NW corner Laurel Ave. & Hermosa St.	389.74
21	Brass cap, 555' South of Tulare Rd. on West side Laurel Ave.	387.57
22	Brass cap, 2' East of East curb return, SE corner Tulare Rd. & Laurel Ave.	387.02
23	Brass cap, 9' South of North end rolled curb on East side LaFayette Ave. just South of Hickory St.	382.71
24	Brass cap, 0.5' North of North curb return, NE corner LaFayette Ave. & Sierra View St.	384.07
25	Brass cap, 1.5' East of East curb return, SE corner Tulare Rd. & LaFayette St.	384.92
26	Brass cap, 1' North of North curb return at LaFayette Ave. & 1st alley South of Denver St. to East.	385.89
27	Brass cap, 2' North of South end curb at NE corner LaFayette Ave. & Hermosa St.	386.38
28	Brass cap, 16' East of $\zeta$ Cambridge Ave. on South side Samoa St.	386.41
29	Brass cap, 2' North of North curb return, NE corner Harvard Ave. & Samoa St.	384.53

BENCH MARK NO.	DESCRIPTION	ELEVATION
30	Brass cap, 3' East of East curb return, SE corner Hermosa St. and Cambridge Ave.	384.68
31	Brass cap, 2' East of East curb return, SE corner Cambridge Ave. & Tulare Rd.	383.50
*32	Brass cap, 2.5' East of East curb return, NE corner Tulare Rd. & Harvard Ave.	380.79
*33	Brass cap, 1' North of South end curb, NE corner Harvard Ave. & Denver St.	382.22
34	Brass cap, 1.5' North of North curb return, NE corner Harvard Ave. & Hermosa St.	383.47
35	Brass cap, 2' North of North curb return, NE corner Harvard Ave. & Honolulu St.	385.37
36	Brass cap, 500'± South of Honolulu St. on East side Harvard Ave. (Approximately North of 188 Harvard Ave.)	386.92
37	Brass cap, 2' North of South end curb, NE corner Harvard Ave. & Valencia St.	389.58
38	Brass cap, 1' North of North curb return, NE corner Valencia St. & Locke Ave.	386.20
39	Brass cap, 1.5' East of East curb return, SE corner Locke Ave. & Lindsay St.	386.98
40	Brass cap, 1' West of West curb return, West end driveway to Lindsay Unified School District Administration Office on North side Honolulu St.	383.99
41	Brass cap, 3.5' North of North curb return, NE corner Homassell Ave. & Second St.	378.72
42	Brass cap, 1' South of South curb return, SW corner Homassell Ave. & Tulare Rd.	377.89
43	Brass cap, 1' East of East curb return, SE corner Homassell Ave. & Alameda St.	375.42
44	Brass cap, 1' East of East curb return, SE corner Homassell Ave. & Sierra View Ave.	374.18

BENCH MARK NO.	DESCRIPTION	ELEVATION
45	Brass cap, 1' North of North curb return, NE corner Homassell Ave. & Mountain View Dr.	373.65
46	Brass cap, 1' East of East curb return, SE corner Homassell Ave. & Garden St.	372.62
47	Brass cap, 1' South of South curb return, SE corner Orange Ave. & Tulare Rd.	379.39
48	Brass cap, 9' North of North curb return, NW corner Orange Ave. & Hermosa St.	381.93
49	Brass cap, 1' South of South curb return, SW corner Alameda St. & Orange Ave.	376.79
50	Brass cap, 1' East of East curb return, SE corner Bond Way & Sierra View St.	372.96
51	Brass cap, 1' North of North curb return, NW corner Bond Way & Alameda St.	375.19
52	Brass cap, E.G. SW corner Alameda St. & Elmwood Ave.	375.10
53	Brass cap, 1' North of North curb return, NW corner Elmwood Ave. & Tulare Rd.	374.85
54	Brass cap, 1' East of East curb return, NE corner Mirage Ave. & Tulare Rd.	375.37
55	Brass cap, at North PL542 Mirage Ave.	376.83
56	Brass cap, 2' North of North curb return, NE corner Mirage Ave. & Frazier St.	377.78
57	Brass cap, West side Mirage Ave. at E.C. 705' North of Lindmore St.	384.85
58	Brass cap, 1' North of North curb return, NE corner Mirage Ave. & Lindmore St.	386.85
59	Brass cap, 475' South of $\bar{C}$ Blue Gum Ave. on Sweetbriar Ave. (East corner at angle point)	375.50
60	Brass cap, 1.5' North of North curb return, NE corner Sweetbriar Ave. & Center St.	374.48

BENCH MARK NO.	DESCRIPTION	ELEVATION
61	Brass cap, 600'± North of Tulare Rd. on Sequoia Ave. (West curb).	371.76
62	Brass cap, 5' South of North end curb on West side Sequoia Ave. 50' North of Emergency Entrance Lindsay Hospital.	371.80
63	Brass cap, South side Tulare Rd. 600'± East of Westwood Ave. in front of Second Fire Hydrant East of Westwood Ave.	370.53
64	Brass cap, 1.5' South of South curb return, SE corner Tulare Ave. & Westwood Ave.	369.43
65	Brass cap, 1' South of South curb return, SW corner Westwood Ave. & Fresno St.	368.35
66	Brass cap, 1' South of South curb return, SW corner Westwood Ave. & Mariposa St.	368.84
67	Brass cap, 1' South of North end curb West side of Westwood at SW corner Westwood Ave. & Kern St.	370.36
68	Brass cap, 0.5' East of East curb return, SE corner Kern St. & Central Ave.	372.57
69	Brass cap, 1' East of East curb return, SE corner Mariposa St. & Central Ave.	371.66
70	Brass cap, East side Mount Vernon Ave. at Mariposa St. (in front of fire hydrant).	373.76
* 71	Brass cap, 1' East of East curb return, NE corner Eastwood Ave. & Hermosa St.	374.47
72	Brass cap, North side Fresno St. 650'± West of Westwood Ave. (East HL 909 Fresno St.)	367.21
73	Brass cap, 1' East of West end curb South side Fresno St. at West City Limits.	365.93
74	Brass cap, 1' North of North curb return NE corner Maple Ave. & Tulare Rd.	367.94
75	Brass cap, 1.5' North of South end curb at NW corner Parkside Ave. & Monte Vista	372.01

BENCH MARK NO.	DESCRIPTION	ELEVATION
76	Bureau of Reclamation B.M. No. 20-26-12E, NW corner Westwood Ave. and Hermosa St.	371.38
77	U.S. Coast & Geodetic B.M. No. E 1230, NE corner Tulare Rd. and Sequoia Ave.	373.06
78	Bureau of Reclamation B.M. No. 20-27-7F, SE corner Tulare Rd. and Mirage Ave.	376.35
* 79	Bureau of Reclamation B.M. No. 20-27-6D, NW corner Tulare Rd. and Harvard Ave.	381.21
80	Bureau of Reclamation B.M. No. 20-27-5H, NW corner Tulare Rd. and Foothill Ave.	388.54

\* BM KNOWN TO BE MISSING



CITY OF LINDSAY  
CALIFORNIA

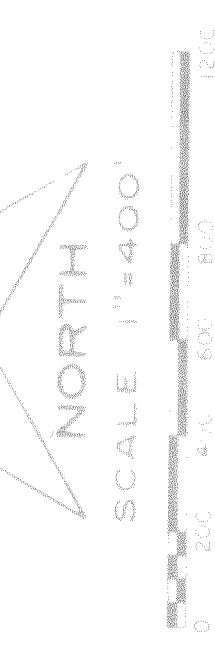

NORTH  
SCALE 1"=400'

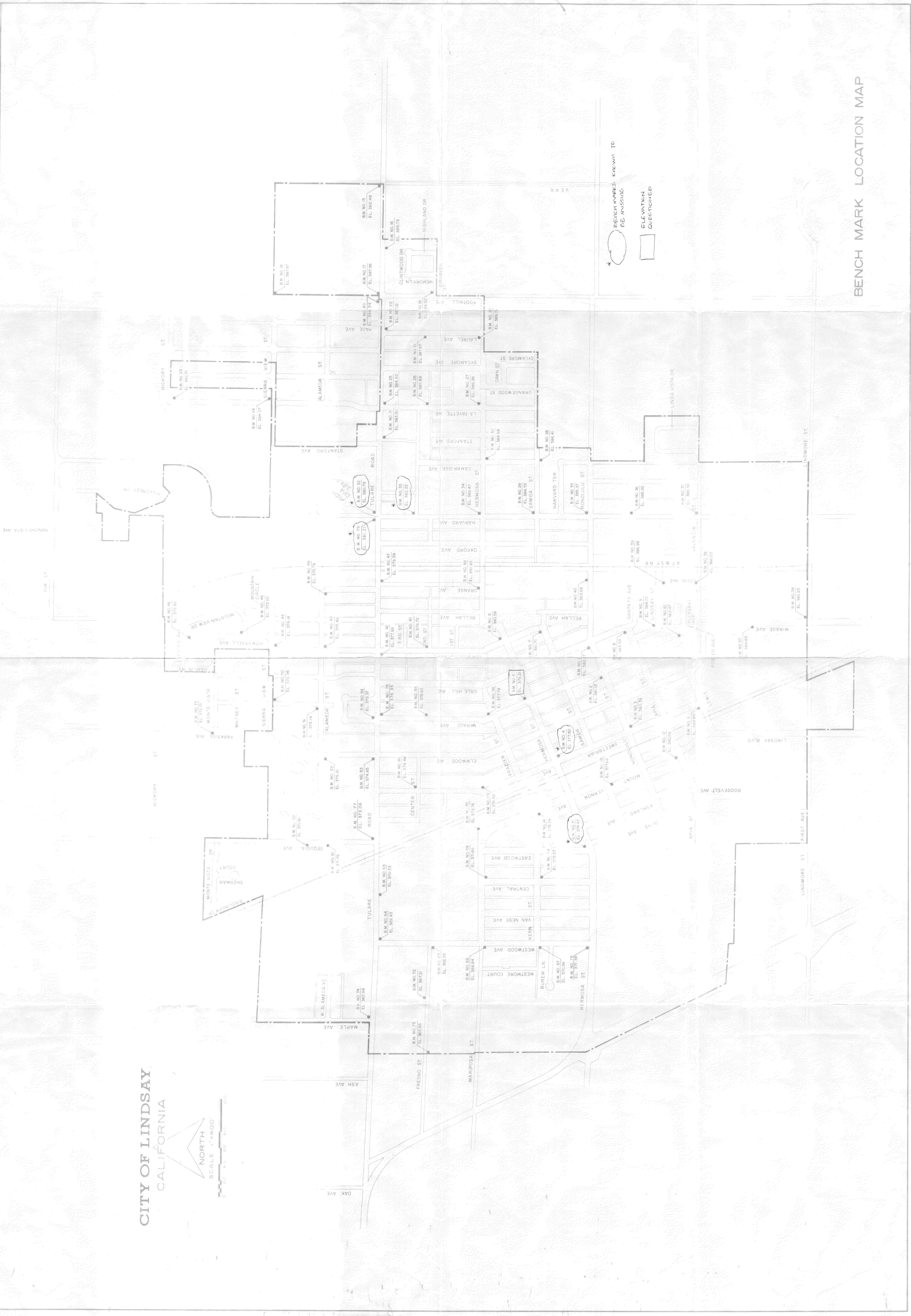

BENCH MARKS KNOWN TO  
BE MISSING  
ELEVATION  
QUESTIONED

BENCH MARK LOCATION MAP